



DEFENDER™ 2500

Drum Scale



Painted & Stainless Steel Floor Stands
(Optional)

Convenient Portability with Floor Scale Capacity

Defender 2500 Drum Scale is a durable portable floor scale designed for industry applications. Defender 2500 features a powder coated carbon steel treaded platform, built-in front/back access ramps, four load cells, and the new i-DT25P indicator for clear display of weighing results. Includes folding stainless steel cleats to store the 20ft. indicator cord. For quick transport, the base can be rotated on its side using the stainless steel handles and moved around the shop floor using the two integrated wheels.

Unique Features Include:

- Our Drum Scales come in five models with two platform sizes of 30" × 30" and 36" × 36", and capacities from 500 to 2,500 lb, allowing greater flexibility to best suit your weighing needs.
- Platform constructed of powder coated carbon steel which enables the scale to stand up to heavy industrial use. Items can be weighed on treaded platform or across side rails for larger items.
- Low-profile design with front/back access ramps allow pallet jacks, carts and drums to be easily rolled onto the platform. Integrated high-density polyurethane wheels enable convenient portability.

DEFENDER™ 2500 Drum Scale

Model	i-DFD25P500E1S	i-DFD25P1000E1S	i-DFD25P2500E1S	i-DFD25P1000E1R	i-DFD25P2500E1R
Capacity × Readability	500 lb × 0.1 lb / 250 kg × 0.05 kg	1,000 lb × 0.2 lb / 500 kg × 0.1 kg	2,500 lb × 0.5 lb / 1,250 kg × 0.2 kg	1,000 lb × 0.2 lb / 500 kg × 0.1 kg	2,500 lb × 0.5 lb / 1,250 kg × 0.2 kg
Platform Dimensions	30 × 30 in. / 762 × 762 mm			36 × 36 in. / 914.4 × 914.4 mm	
Deck Material	Painted Carbon Steel, Treaded Surface, Fixed Top Plate				
Feet	4 × Swivel Design, Screw-In, Carbon Steel with Rubber Bottom Cap, Top Adjustable				
Maximum Central Load	100% of Maximum Capacity				
Load Cell	4 × IP67 Nickel Plated Alloy Steel Load Cells, Shear Beam				
Junction Box	IP65, Die-cast Aluminum, with 6 m (20 ft) Indicator Cable				
Operating Temperature	50 °F to 104 °F / 10 °C to 40 °C				
Indicator	i-DT25P, ABS plastic housing				
Weighing Units	lb, kg				
Modes	Weighing, Parts Counting, Totalization, Dynamic Weighing/Display Hold, Peak Hold				
Display	6-digit, 7-segment LCD display with white backlight, 1.1 in./28 mm high digits				
Keypad	4 Function Mechanical Switches and Raised Tactile Keys				
Stabilization Time	Within 1 seconds				
Auto-zero Tracking	Off, 0.5, 1 or 3d				
Zeroing Range	2% or 100% of capacity				
Span Calibration	5 lb or kg to 100% of capacity				
Interfaces	RS232 & USB (Type C) Standard				
Power	Standard AC adapter with USB type C cable, detachable (included) or 4 AA batteries (not included)				
Battery	20 hours continuous use with backlight off				
Indicator Dimensions (W × D × H)	8.0 × 4.1 × 1.7 in / 205 × 105 × 43 mm				
Scale Shipping Dimensions (W × D × H)	41.1 × 40.2 × 7.9 in. / 1,044 × 1,022 × 200 mm			46.9 × 46.3 × 7.9 in. / 1,190 × 1,175 × 200 mm	
Scale Net Weight	101 lb / 46 kg			126 lb / 57 kg	
Scale Shipping Weight	110 lb / 50 kg			135 lb / 61 kg	

Other Standard Features and Equipment

Selectable environmental and auto-print settings, stability indicator, overload/underload indicators, auto-off, auto tare.

Alloy steel feet with top height adjustment. Parts Counting and Checkweighing modes for packaging and checking inventories, Totalization mode allows running tally of weight totals, Dynamic Weighing/Display Hold feature with selectable weight threshold for wheelchair and medical weighing, painted and stainless steel floor stands (available as accessories)

Compliance

- **Product Safety (indicator):** UL 61010-1; CAN/CSA C22.2 61010-1; IEC/EN 61010-1
- **Electromagnetic Compatibility:** IEC/EN 61326-1 Class B, basic environments; FCC Part 15 Class A; Canada ICES-003 Class A
- **Compliance Marks:** CSA, CE
- **Other:** WEEE, RoHS

Accessories

Cable, RS232, Male-to-Female	80500525	Column Kit, Painted, Floor Scale	30531244
DB9 Adapter, Male-to-Male	30692384	Column Kit, Stainless Steel, Floor Scale	30539553
Auxiliary Display, AD7-MD	30472063	Interface Kit, RS232-USB	30304101
SF40A Printer (US)	30064203	Interface Kit, RS232-Ethernet	30304102
Printer, Thermal, STP-103, US	80251992		

Dimensions

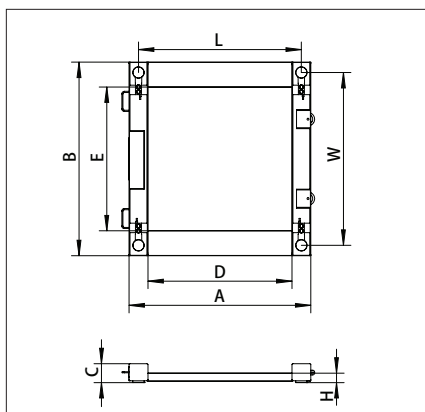

	30" × 30" 762 × 762 mm	36" × 36" 914.4 × 914.4mm
A	37.9 in. / 962 mm	43.9 in. / 1,114.4 mm
B	40.4 in. / 1,024 mm	46.1 in. / 1,170 mm
C	4 in. / 100 mm	4 in. / 100 mm
D	30 in. / 762 mm	36 in. / 914.4 mm
E	30 in. / 762 mm	36 in. / 914.4 mm
H	2 in. / 50 mm	2 in. / 50 mm
W	34 in. / 862 mm	41.8 in. / 1,060.4 mm
L	36 in. / 914.4mm	40 in. / 1,014.4 mm

80776905_A_20240403 © Copyright OHAUS Corporation

OHAUS CORPORATION

Tel: 800.672.7722

973.377.9000

Fax: 973.944.7177

www.ohaus.com

The management system governing the manufacture of this product is ISO 9001:2015 certified.

